

MICROFILMED

WESTMORELAND CIRCLE
SPRING STREET (PINE STREET)

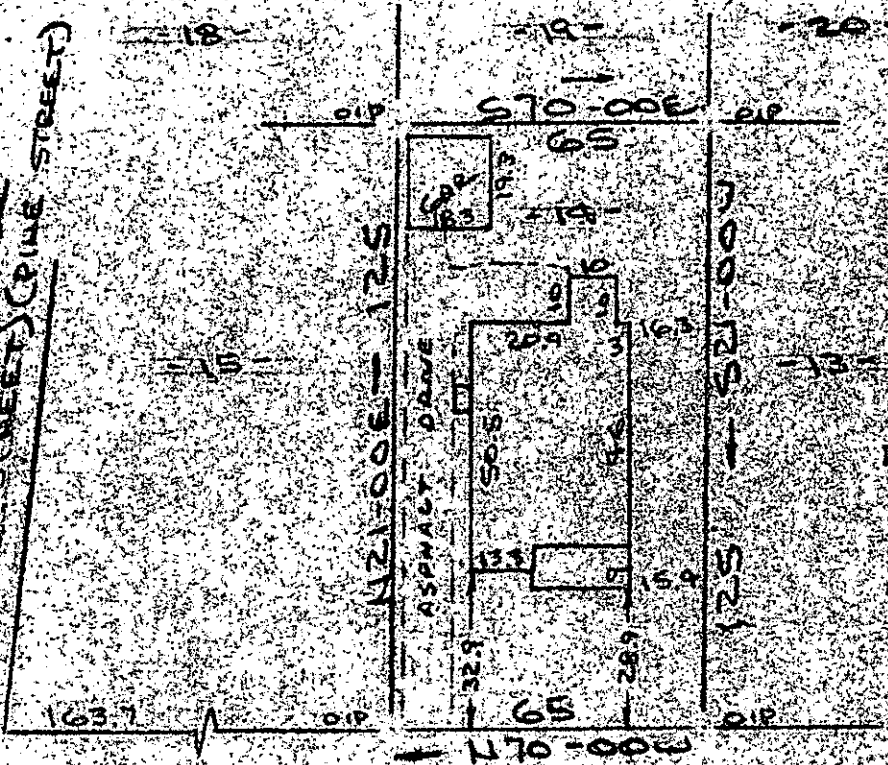

Note: Improvements on this lot are not in a Flood Hazard area.

REC'D JUN 25 12 25 PM '85
GREENVILLE, S.C.
DORRIS W. CARLISLE
SURVEYOR

WESTMORELAND AVENUE
WATER & SEWER IN ST. R/W

PROPERTY OF
JAMES M. BAILEY
GREENVILLE COUNTY, GREEN, S.C.
SCALE 1" = 40' 28 JUNE 1985



This is to certify that on the 25th day of June, 1985, I surveyed the property shown on this plat, being known as lot 14 as part of RES. L. V. GINTERMAN and recorded in the REC. Office Greenville County, S. C., in Plat Book "F" at Page 17; and that the property lines, walls and buildings are as shown hereon, and that the walls and buildings located on said lot do not encroach or project on adjacent street or property, and that no adjacent walls or buildings encroach or project on said premises, and no power lines cross this property except as shown hereon.

39901

JUN 28 1985

11R-61

R. B. BRUCE

R. B. BRUCE, PLS. / 1982

Recordable Plat

CAROLINA SURVEYING CO.
112 Manly St.
Greenville, S. C.

263/210

072-12-10